

User Manual for Manual Backwash Disk Prefilter

0WRX.466.806

1. Main Application

Used for filtering municipal water treatment. Coarse filtration. Can intercept larger particles, for protecting the back water equipment. Suitable for installation in house.

2. Product Characteristics

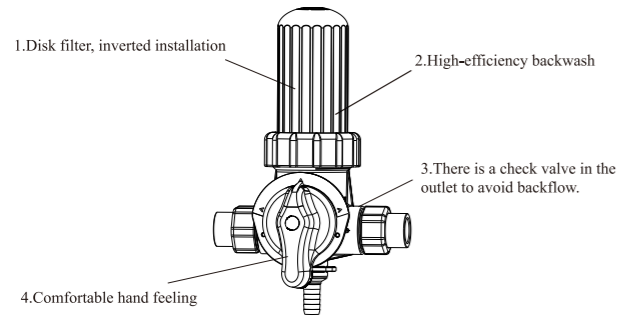

3. Technical Parameters

Model	Nominal Size	Rated Water Flow m ³ /h	Rated Treated Water Quantity m ³	Filtration Precision μm	Remark
RL-Q01	DN20	1.5	1000	50	BS
Operating Conditions:					
Working pressure: 0.1~0.6MPa			Working water temperature :5~50℃		
Environment temperature: 5~50℃;			Relative humidity: ≤95% (25℃)		

Note: Rated treated water quantity is related to raw water quality, the more grain particles containing, the less water quantity will be.

4. Product Dimensions

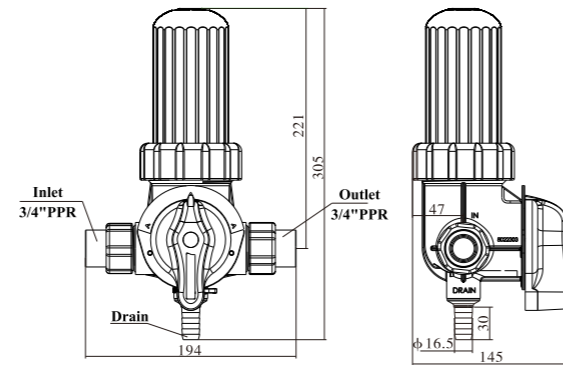

Remark: All dimensions above are in mm.

5. Installation Notes

1. Installation conditions should conform to the requirements of the product work environment.
2. It should be installed after water meter, but in front of other equipment, and avoid installing outdoors.
3. It should stay away from hydrops, no exposure to rain or sunlight.
4. If pipeline pressure changes suddenly, please install pressure reducing valve.
5. Please avoid subsurface pipe when drilling during the installation of screw.
6. The installation position requirements for drain and maintenance are shown in the following figure.
7. If you have any questions, please feel free to contact our after-sales service or professionals.
8. During installation, pay attention to placing a sealing ring at the PPR connector and observe whether the outlet check valve is installed properly.

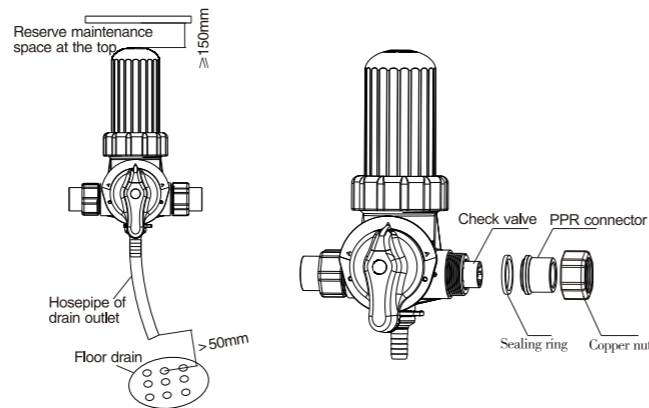

6. Operating Instructions

When first installation, check whether each connector is installed properly. Slowly open the main water inlet for trial operation to ensure that each station is working normally. Check for any leaks. If there are no leaks, switch to the backwash state. After continuous backwash for 10 minutes, switch to the service state and start using water.

Under normal daily use, if the water output significantly decreases, it needs to be backwashed once. It is recommended to control the backwash time between 15-20 seconds. If the water quality is poor, the backwash frequency can be appropriately increased. When repairing and maintaining backend equipment or adding equipment, it can be turned to the "Close" position for easy operation, without the need to control the main valve of the water inlet pipeline.

7. Maintenance (Suggested Once a Year)

Steps:

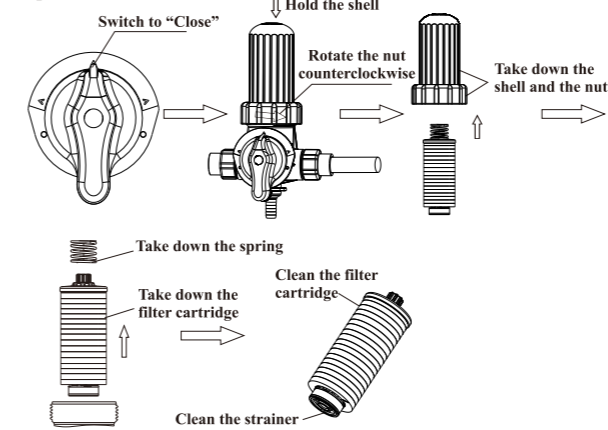

After clean, repeat above steps backward to assemble all the parts and check its seal for later use.

8. Packing List

When unpacking the product, please check below spare parts.

No.	Description and Specification	Quantity	Diagram
1	Prefilter	1	
2	Clamp	2	

3	Copper nut	2	
4	3/4" PPR Connector	2	
5	Sealing Ring	2	
6	Hosepipe	1	
7	User Manual	1	

9. Pressure-Flow Rate Curve

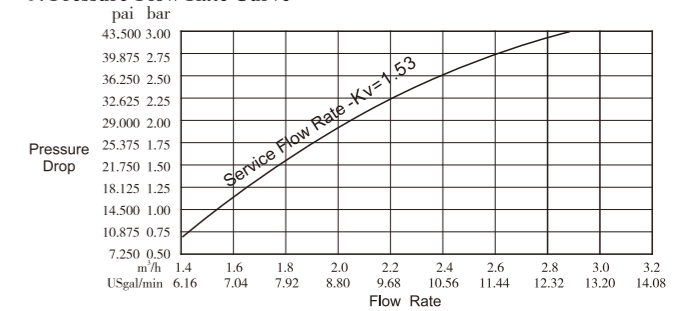

10. Warranty Card

Dear client:

This warranty card is the guarantee proof of Manual Backwash Disk Prefilter. It is kept by client itself, you could get the after-sales services from the supplier which is appointed by manufacturer. Please keep it properly. It couldn't be retrieved if lost. It couldn't be repaired free of charge under the below conditions:

1. Guarantee period expired. (18 month from the manufacturing date).
2. Damage resulting from using, maintenance, and keeping that are not in accordance with the instruction.
3. Damage resulting from repairing not by the appointed maintenance personnel.
4. Content in guarantee proof is unconfirmed with the label on the real good or be altered.
5. Damage resulting from force majeure.

Product Name				Manual Backwash Disk Prefilter			
Model		Code of valve body		Purchase Company Name		Tel./Cel.	
Problem				Solution			
Date of Repairing		Date of Accomplishment		Maintenance Man Signature			

When product need warranty service, please fill the form and send this card together with the product to the appointed suppliers.